



Montana

PANTON WIRE

MONTANA ACADEMY

Shared visions

When Peter J. Lassen, the founder of Montana, first met the young Danish architect Verner Panton in 1956, neither of them was aware that this would be the beginning of a close friendship and life-long collaboration.

The strong bond and shared history between Verner Panton and Peter J. Lassen has made it a natural choice for Montana to manufacture several of Verner Panton's designs.



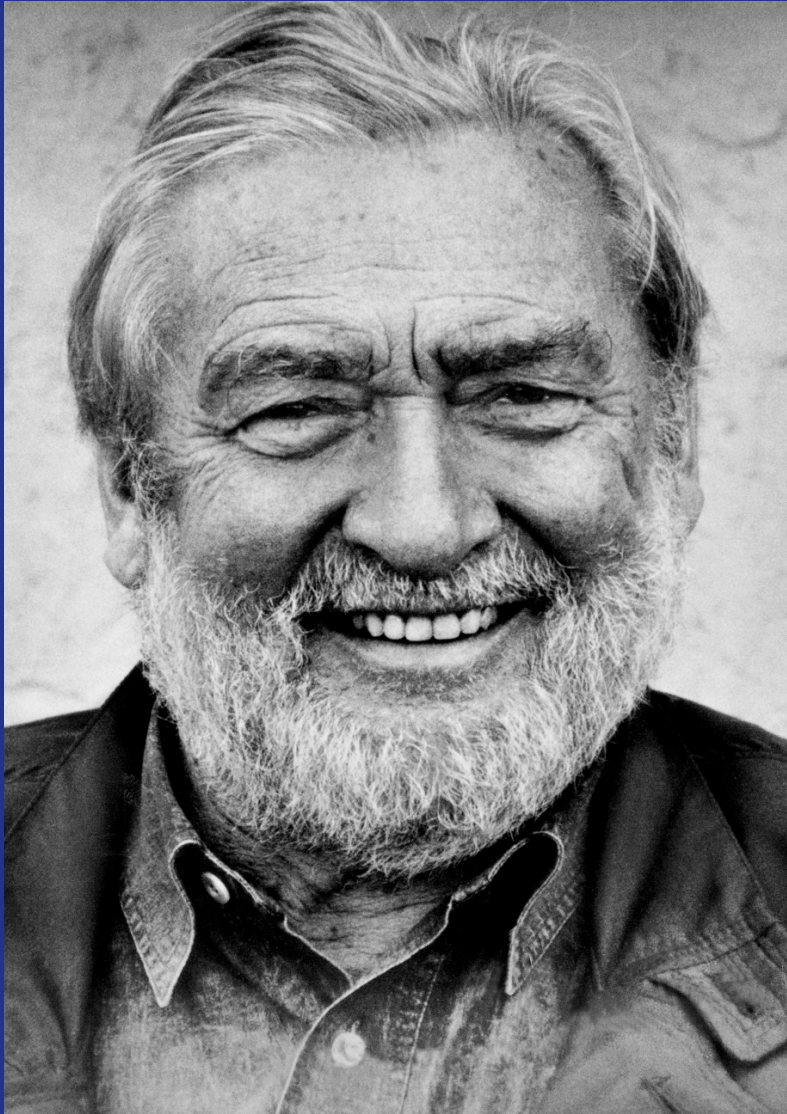

A life in colours

Verner Panton (1926–1998) is regarded as one of Denmark's most influential 20th-century furniture and interior designers. He is celebrated for his persistent use of bold colours and organic shapes, as well as his groundbreaking use of materials and, for its time, innovative approaches to industrial furniture production methods.

Panton is synonymous with vibrant colours and fluid, organic forms. However, during his collaboration with Peter Lassen in the 1970s, he also showcased an impressive approach to system thinking.

Throughout his career, Panton created innovative and futuristic designs using a variety of materials, particularly plastics and steel, and always embraced vibrant, dynamic colour schemes.

Panton Wire

A versatile shelving system designed by Verner Panton in 1971.

Use Panton Wire next to the bed or the sofa, as a light room divider – or hang the units on the wall.

The modules invite an infinite number of combinations and can be used everywhere: At home, in the store, as a bookshelf, in the bathroom.





PANTON WIRE

Marble top plate is available for Panton Wire



PANTON WIRE

Panton Wire in Black Red with Monarch top plate

2 Heights

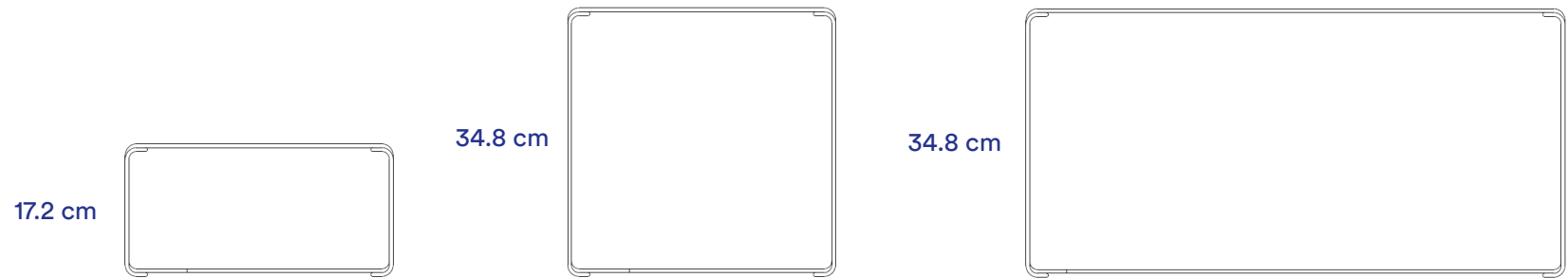

2 Depths

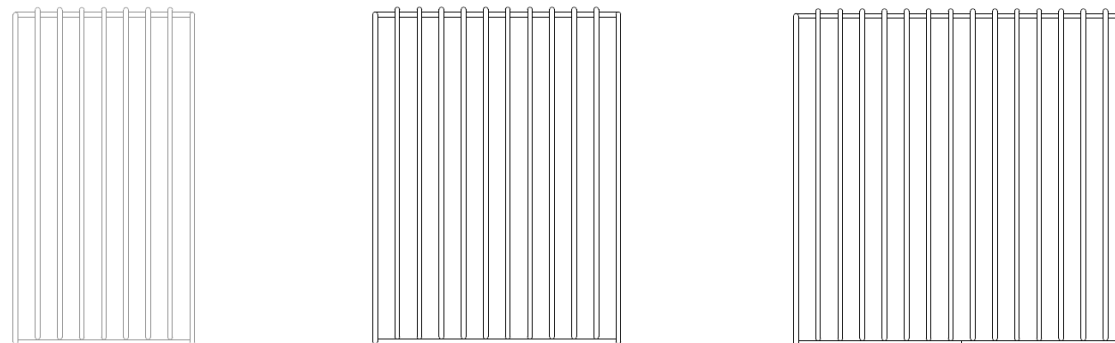

18.8 cm*

25.7 cm

34.8 cm

*Depth 18.8 cm will be discontinued when stock is sold out

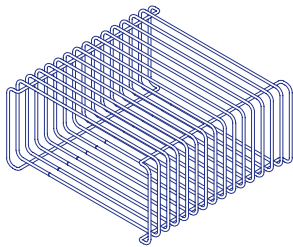

7661T D35
H 17.2 cm / W 34.8 cm / D 34.8 cm

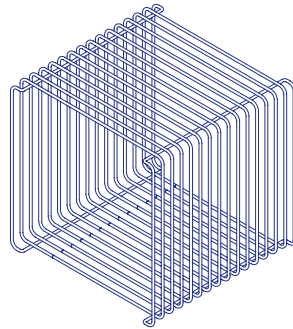

6161T D35
H 34.8 cm / W 34.8 cm / D 34.8 cm

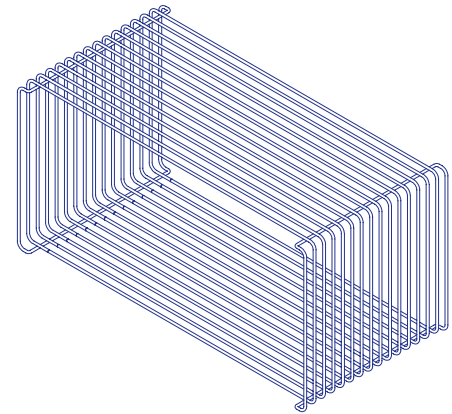

6111T D35
H 34.8 cm / W 70 cm / D 34.8 cm

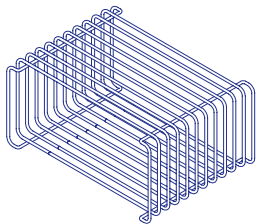

7661T D26
H 17.2cm / W 34.8 cm / D 25.7 cm

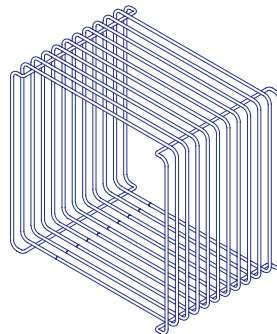

6161T D26
H 34.8 cm / W 34.8 cm / D 25.7 cm

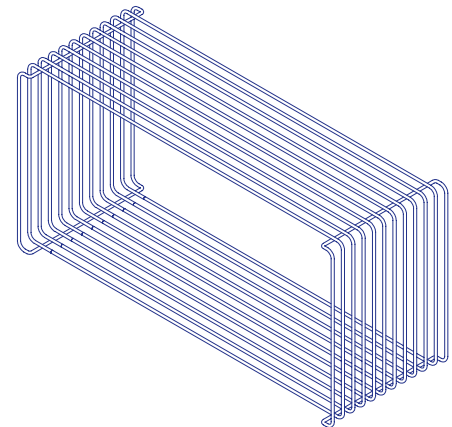

6111T D26
H 34.8 cm / W 70 cm / D 25.7 cm

Panton Wire



43
Chrome



05
Black

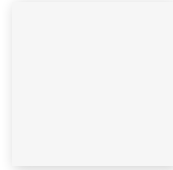

38
Snow



136
Pine



135
Monarch



07
Black Red



145
Rosehip



Top panels



992
White Marble



995
Black Marble



05
Black



101
New White



136
Pine



135
Monarch



07
Black Red



145
Rosehip

Inlay shelves



05
Black



101
New White



136
Pine



135
Monarch



07
Black Red



145
Rosehip



-
Clear glass



PANTON WIRE

Panton Wire is always delivered with both suspension and feet

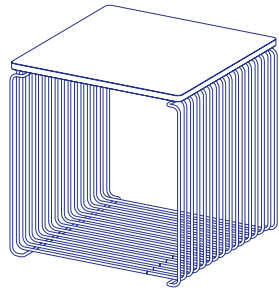

Top panel

Height: 1.2 cm
Width: 34.8 cm
Depth: 34.8 cm

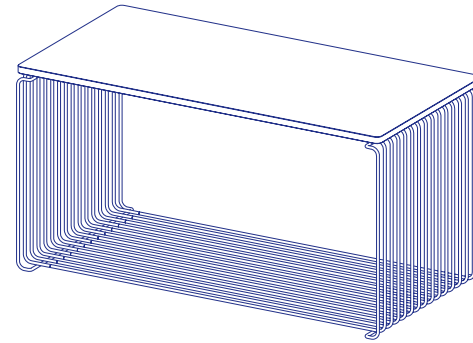

Top panel

Height: 1.2 cm
Width: 70.1 cm
Depth: 34.8 cm

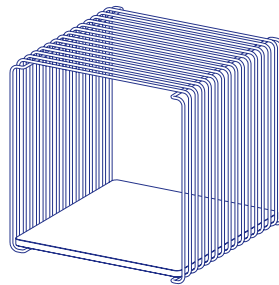

Inlay shelf

Height: 1.2 cm
Width: 33 cm
Depth: 34.8 cm

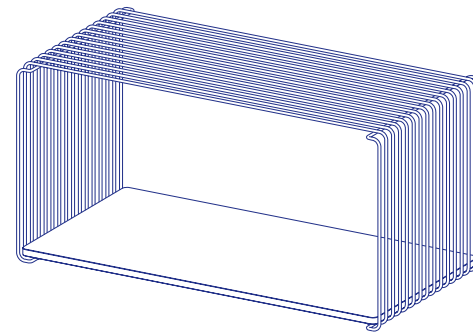

Inlay shelf

Height: 1.2 cm
Width: 68.2 cm
Depth: 34.8 cm



PANTON WIRE
Depth 25.7 cm configuration

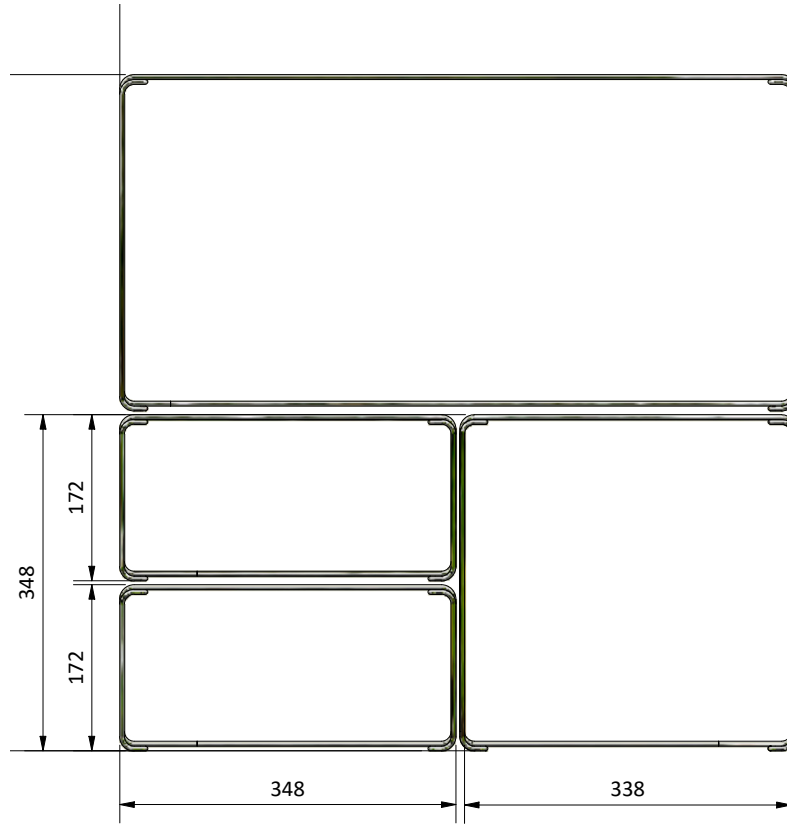

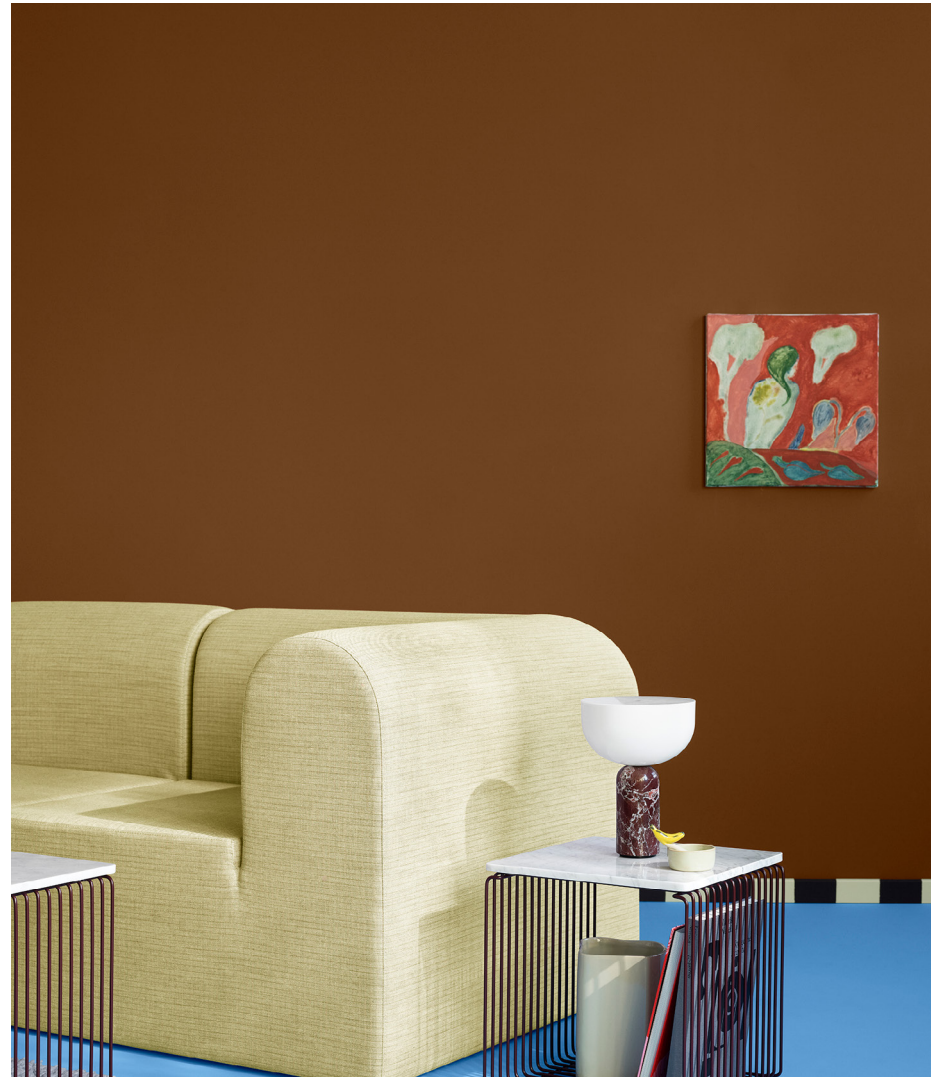

PANTON WIRE

Marble top plate is available for Panton Wire



Specifications

Materials

Panton Wire is made from 5 mm steel.

Components

Panton Wire is always supplied with feet and clips for joining, and two suspension brackets for wall mounting.

Max load

Each unit can bear loads of up to 40 kg when standing on the floor and 10 kg when mounted on the wall.

Stability

Modules higher than 70 cm must be secured to the wall with a security strip. All modules are delivered with one security strip.



PANTON WIRE
Panton Wire in Black Red



PANTON WIRE

Pantonova which led the way to the Wire design - designed for Restaurant Varna, Aarhus 1971

EU Ecolabel

The EU Ecolabel is a label of environmental excellence. Recognized across Europe and worldwide.

Awarded to products that meet high environmental standards throughout their life cycle. Less waste and less CO₂ during production. Durable, easy to repair and recyclable quality and design.

The EU Ecolabel provides exigent guidelines and offers third party controls and audits.



Always updated on..

Montana Digital Showroom

Montana official website



Montana